

SHANGHAI CIHPY INDUSTRY CO.,LTD.

ANSI CLASS 150/300/600/900 CARBON STEEL OR STAINLESS STEEL GLOBE VALVE BOLTED BONNET DESIGN

MODEL NO: SCAXRF-000



GLOBE VALVE PRODUCT'S SIZE:

PRESSURE GRADE	FROM	TO
CLASS 150	1/2"	8"
CLASS 300	1/2"	8"
CLASS 600	1/2"	6"

DESIGN DESCRIPTION:

- * BOLTED BONNET;
- * FULLY GUIDER;
- * INTEGRAL SEATS;
- * HANDWHEEL OPERATOR;
- * AVAILABLE WITH GEAR OPERATOR;
- * FLANGED ENDS OR BUTT-WELDING ENDS;
- * RISING FLANGE OR RING TYPE JOINT.

WORKING PRESSURE AND TEMPERATURE

WORKING TEMPERATURE		
MATERIAL	CELSIUR SCALE	FAHRENHEIT
CARBON STEEL	-290C~4250C	60F~8220F
STAINLESS STEEL	-400C~5500C	150F~10470F

GENERAL DESIGN SPECIFICATIONS:

ITEM	AMERICAN STANDARD	BRITISH STANDARD
MANUFACTURE	API 6D OR API 600	BS 1873
PRESSURE-TEMPERATURE RATINGS	ANSI B16.34	BS 1560
FACE TO FACE	ANSI B16.10	BS 2080
END TO END	ANSI B16.10	BS 2080
END FLANGE	ANSI B16.5	BS 1560
END BUTT-WELDING	ANSI B16.25	BS 1873
GASKET CONTACT	ANSI B16.5	BS 1560
INSPECTION AND TEST	API 598	BS 6755 PART 1

TEST PRESSURE TO API 598 OR BS 6755 PATRT 1

CLASS	SHELL (WATER)		SEAT (WATER)		SEAT (AIR)		BACK SEAT(WATER)	
150	3.1MPA	450PSI	2.2MPA	315PSI	0.6MPA	80PSI	3.1MPA	450PSI
300	7.8MPA	1125PSI	5.6MPA	815PSI	0.6MPA	80PSI	7.8MPA	1125PSI
600	15.3MPA	2225PSI	11.2MPA	1630PSI	0.6MPA	80PSI	15.3MPA	2225PSI

TRIMS SPECITIED DUE TO TABLE 3:

DISC SEAT SURFACE PART NO.3	BODY SEAT SURFACE PART NO.2	STEM PART NO.4	BACKETSEAT PART NO.9
F6	F6	F6	F6
STELLITE	STELILITE	F6	F6
F6	STELILITE	F6	F6
304	304	F304	F304
316	316	F316	F316
304L	304L	F304L	F304L
316L	316L	F316L	F316L
OTHER MATERIALS ARE AVAILABLE UPON REQUEST.			

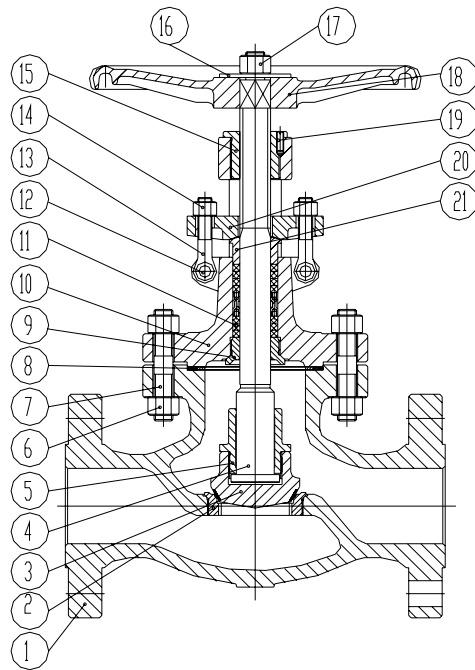

PARTS AND MATERIAL (ASTM)

NO	PARTS NAME	MATERIAL				
1	BODY	A216-WCB	A351-CF8	A351-CF8M	A351-CF3	A351-CF3M
5	STEM BOLT	A216-WCB	A351-CF8	A351-CF8M	A351-CF3	A351-CF3M
6	BONNET BOLT NUT	A1942H	A1948	A1948	A1948	A1948
7	BONNET BOLT	A193B7	A193B8	A193B8	A193B8	A193B8
8	GASKET	REINFORCED FLAT GRAPHITE, OR SS SPIREAL WOUND W/GRAPHITE OR PTFE, OR REINFORCEPTFE				
10	BONNET	A216-WCB	A351-CF8	A351-CF8M	A351-CF3	A351-CF3M
11	STEM PACKING	BRAIDED GRAPITE OR DIEFORMED GRAPHITE RING OR PTFE				
12	EYE BOLT PIN	STEEL	STAINLESS STEEL	STAINLESS STEEL	STAINLESS STEEL	STAINLESS STEEL
13	EYE BOLT	A193B7	A193B8	A193B8	A193B8	A193B8
14	EYE BOLT NUT	A1942H	A1948	A1948	A1948	A1948
15	STEM NUT	A216-WCB	A351-CF8	A351-CF8M	A351-CF3	A351-CF3M
16	NAME PLATE	STAINLESS STEEL OR ALUMINUM				
17	H.W.LOCK NUT	STEEL				
18	HANDWHEEL	DUCTILE IRON				
19	LOCK NUT	STEEL				
20	GLAND FLANGE	A105	SS304	SS316	SS304L	SS316L
21	GLAND	A182F6	SS304	SS316	SS304L	SS316L

OTHER MATERIALS ARE AVAILABLE UPON REQUEST.

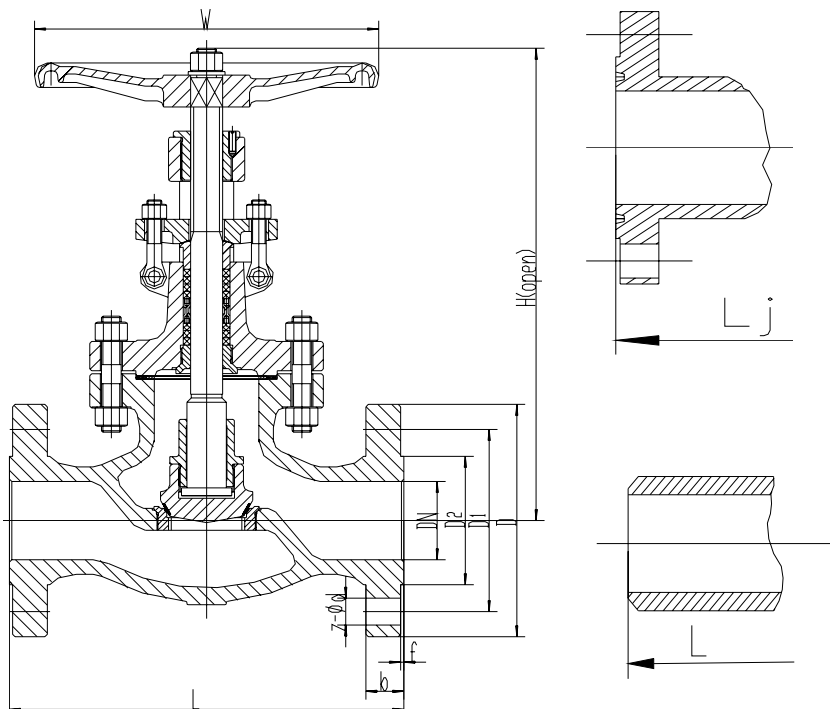

DIMENSIONS LIST(UNIT:inch):

CLASS 150 GLOBE VALVE FLANGE END AND WLEDING END

DN	NPS	F(mm)	L	LJ	D	D1	D2	b	Z*Φd	W	H(OPEN)	Wt(kg)
15	1/2	2.1	4-1/4	-	3-1/2	2-3/8	1-3/8	-	4*5/8	4	7-1/8	3.5
20	3/4	2.1	4-5/8	-	3-7/8	2-3/4	1-11/16	-	4*5/8	4	7-1/2	3.9
25	1	2.1	5	-	4-1/4	3-1/8	2	7/16	4*5/8	4-3/4	8-1/2	5.8
40	1-1/2	2.1	6-1/2	-	5	3-7/8	2-7/8	9/16	4*5/8	5-1/4	10	10.8
50	2	2.1	8	-	6	4-3/4	3-5/8	5/8	4*3/4	7-7/8	13	20
65	2-1/2	2.1	8-1/2	-	7	5-1/2	4-1/8	11/16	4*3/4	9-7/8	14-1/8	32
80	3	2.1	9-1/2	-	7-1/2	6	5	3/4	4*3/4	11	15-3/8	42
100	4	2.1	11-1/2	-	9	7-1/2	6-3/16	15/16	8*3/4	11-3/4	17-1/2	64
150	6	2.1	16	-	11	9-1/2	8-1/2	1	8*7/8	13-3/4	20-1/2	114
200	8	2.1	19-1/2	-	13-1/2	11-3/4	10-5/8	1-1/8	8*7/8	15-3/4	24	186

CLASS 300 GLOBE VALVE FLANGE END AND WLEDING END

15	1/2	2.1	6	6-7/16	3-3/4	2-5/8	1-3/8	9/16	4*5/8	4	6-3/8	3.7
20	3/4	2.1	7	7-1/2	4-5/8	3-1/4	1-11/16	5/8	4*3/4	4-3/4	6-5/8	5.3
25	1	2.1	8	8-1/2	4-7/8	3-1/2	2	11/16	4*3/4	5	7-5/8	7.3
40	1-1/2	2.1	9	9-1/2	6-1/8	4-1/2	2-7/8	13/16	4*7/8	6-5/8	9-1/4	15.4
50	2	2.1	10-1/2	11-1/8	6-1/2	5	3-5/8	7/8	8*3/4	7-7/8	15-1/4	26
65	2-1/2	2.1	11-1/2	12-1/8	7-1/2	5-7/8	4-1/8	1	8*7/8	7-7/8	16-1/2	40
80	3	2.1	12-1/2	13-1/8	8-1/4	6-5/8	5	1-1/8	8*7/8	11	17-1/4	50
100	4	2.1	14	14-5/8	10	7-7/8	6-3/16	1-1/4	8*7/8	13-3/4	20-1/4	90
150	6	2.1	17-1/2	18-1/8	12-1/2	10-5/8	8-1/2	1-7/16	12*7/8	15-3/4	26	160
200	8	2.1	22	22-5/8	15	13	10-5/8	1-5/8	12*1	17-3/4	35-1/2	290

CLASS 600 GLOBE VALVE FLANGE END AND WLEDING END

15	1/2	6.4	6-1/2	6-7/16	3-3/4	2-5/8	1-3/8	9/16	4*5/8	4	6-3/8	4.5
20	3/4	6.4	7-1/2	7-1/2	4-5/8	3-1/4	1-11/16	5/8	4*3/4	5-1/2	6-5/8	7.3
25	1	6.4	8-1/2	8-1/2	4-7/8	3-1/2	2	11/16	4*3/4	6-1/4	7-5/8	9.6
40	1-1/2	6.4	9-1/2	9-1/2	6-1/8	4-1/2	2-7/8	7/8	4*7/8	7-1/2	9-1/4	19
50	2	6.4	11-1/2	11-5/8	6-1/2	5	3-5/8	1	8*3/4	10	14-1/4	35
65	2-1/2	6.4	13	13-1/8	7-1/2	5-7/8	4-1/8	1-1/8	8*7/8	10-1/2	15-1/2	50
80	3	6.4	14	14-1/8	8-1/4	6-5/8	5	1-1/4	8*7/8	12	18-1/4	60
100	4	6.4	17	17-1/8	10-3/4	8-1/2	6-3/16	1-1/2	8*1	15-3/4	21-1/2	110
150	6	6.4	22	22-1/8	14	11-1/2	8-1/2	1-7/8	12*1-1/8	19-1/2	34-3/4	230

*** We hereby reserve the rights of any alternative dimension that would help to improve our valve's quality and working efficiency**



SHANGHAI CIPHY INDUSTRY CO.,LTD
7G-1 Building, N0.515 Yishan Rd.
Shanghai, China
TEL:+86-21-5497 5962
FAX:+86-21-5497 5963
HTTP://WWW.CIPHY.CN
CIPHY@CIPHY.COM
COPYRIGHT©2004-[CIPHY]
ALL RIGHTS RESERVED